

SP300-TAB
PLASTIC TAB FOR SP100 / SP300
(4 LOCATIONS)
LOCKS STARLINK DISH INTO POSITION
ON STARPOD TOP / FRONT HOUSING

S69
PHILLIPS PAN HEAD SCREWS
FOR SHEET METAL, 18-8
STAINLESS STEEL, NUMBER 12
SIZE, 1" LONG NO.3 DRIVE
(4 LOCATIONS)
INSTALL WITH W10 EXTERNAL
TOOTH LOCK WASHER

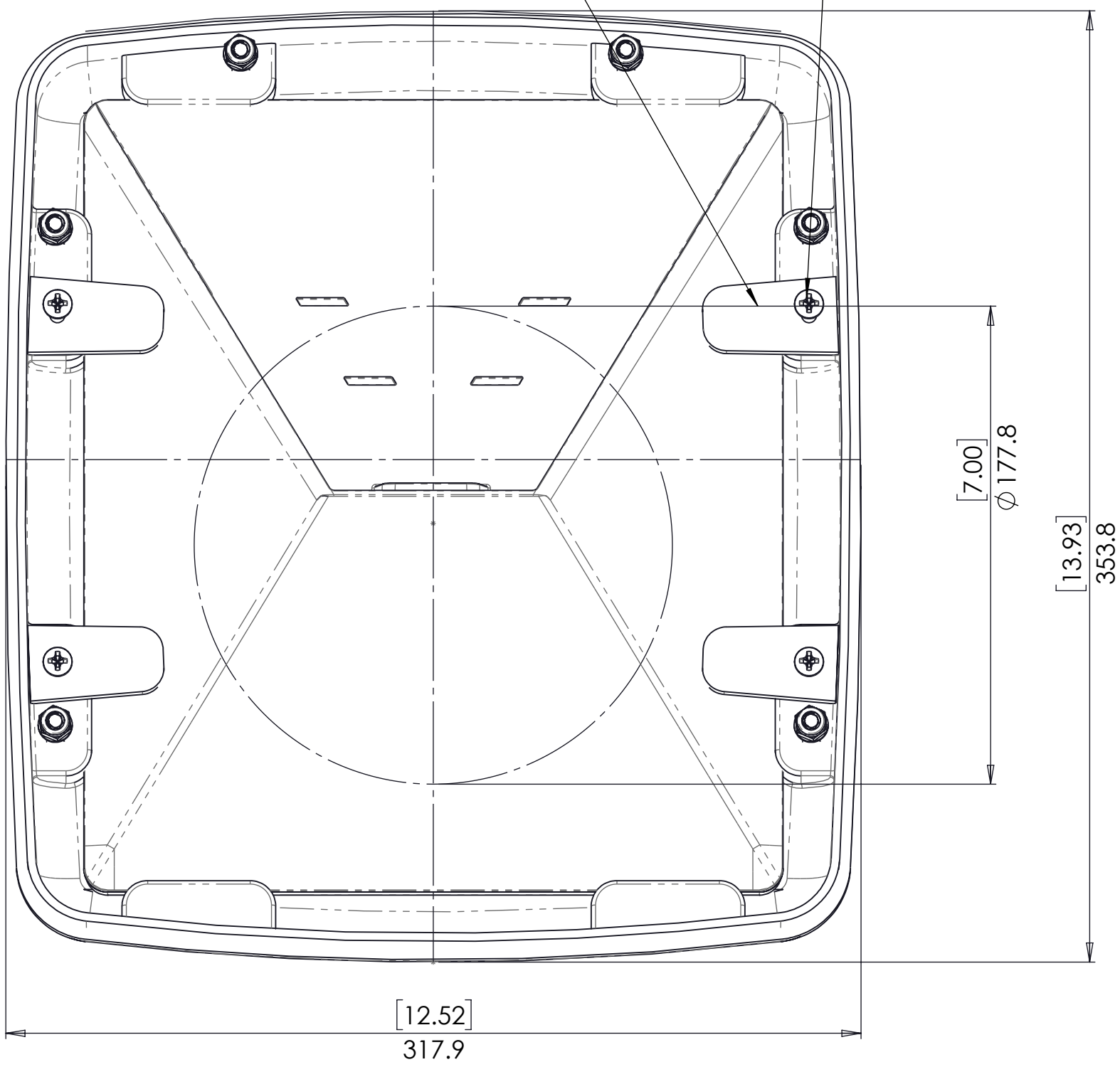

INSERTION OF STAR LINK MINI INTO STARPOD TOP HOUSING

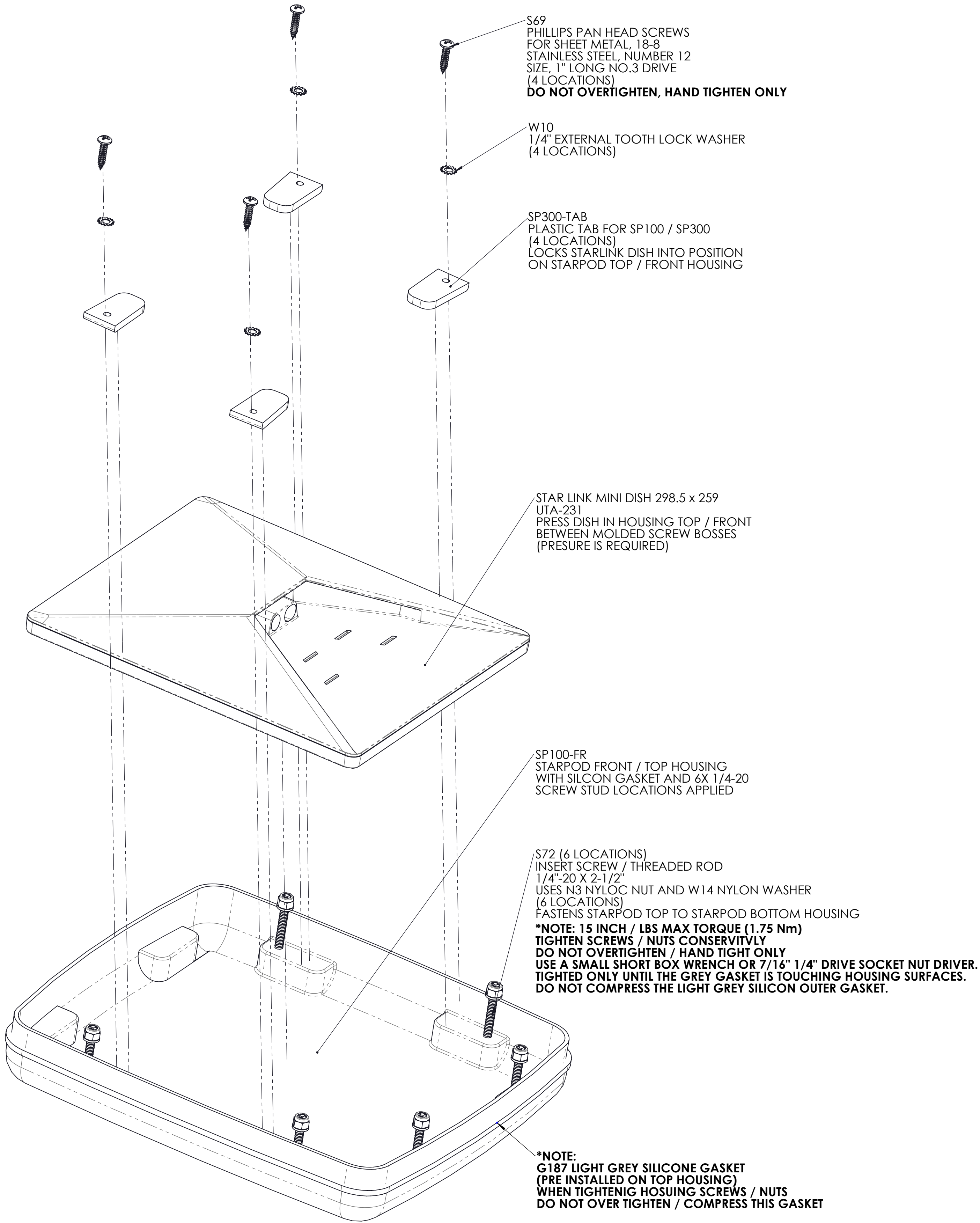

SP100-ASEMBLY-STEP

PROPRIETARY AND CONFIDENTIAL
THE INFORMATION CONTAINED IN THIS
DRAWING IS THE SOLE PROPERTY OF
OCEAN EQUIPMENT. ANY
REPRODUCTION IN PART OR AS A WHOLE
WITHOUT THE WRITTEN PERMISSION OF
OCEAN EQUIPMENT IS
PROHIBITED.

UNLESS OTHERWISE SPECIFIED:		NAME	DATE	OCEAN EQUIPMENT	
DIMENSIONS ARE IN INCHES		DRAWN	MDJ	TITLE:	
TOLERANCES:		CHECKED		INSTALLATION OF STARLINK MINI INTO	
FRACTIONAL: ±		ENG APPR.		STARPOD SP100 HOUSING TOP / FRONT	
ANGULAR: MAACH ± BEND ±		MFG APPR.		SIZE DWG. NO.	
TWO PLACE DECIMAL ±		Q.A.		D	
THREE PLACE DECIMAL ±		COMMENTS:		REV	
INTERPRET GEOMETRIC				2.1	
TOLERANCING PER:				SCALE: 1:2 WEIGHT:	
MATERIAL				SHEET 2 OF 2	
FINISH					
NEXT ASSY	USED ON				
APPLICATION	DO NOT SCALE DRAWING				